

Fold Bow

It's so easy to make a fabulous bow with the Mini Bowdabra®! This technique is great for ribbon that is the same on both sides.

Materials Needed: the Mini Bowdabra®, the Mini Bowdabra® Wand, ribbon that is the same on both sides, coordinating ribbon to use as a tie, and, if you would like, a small embellishment, such as a silk flower.

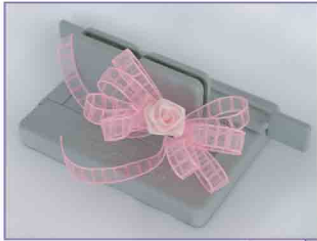

1.



Lay a 12" piece of coordinating ribbon the long way into the Mini Bowdabra® to be used to tie off your bow.

2.



Determine the length you want your bow's tails to be as you lay the ribbon into the Mini Bowdabra®. Next determine the size of your loops.

To make your first loop, fold the ribbon and press into the Bowdabra®. Continue

folding the ribbon back and forth until you have created as many loops as you desire.

3.



Use the Mini Bowdabra® Wand to scrunch down the ribbon.

4.



Press the stem of your silk flower down into the Mini Bowdabra® directly above the folded length of ribbon.

5.



While the bow is still in the Bowdabra®, take the ends of the tie ribbon and tie it off (don't knot it.) Gently pull the bow out of the Mini Bowdabra®. Take the ends of the tie ribbon around to the back of the bow and tie a knot.

6.



Fluff and shape the bow to create the desired appearance, trim the bow's tails so they are the same length, and trim the bow tie.

Scrunchy Bow

It is simple to create a dazzling scrunchy bow with the Mini Bowdabra®.



Materials Needed: the Mini Bowdabra®, the Mini Bowdabra® Wand, tulle or other wide ribbon, and coordinating ribbon to use as a tie.

1.



Lay a 12" piece of coordinating ribbon the long way into the Mini Bowdabra® to be used to tie off your bow.

2.



Slide the tulle or other wide ribbon directly into the Mini Bowdabra® from the top. The ribbon piles up like an accordion.

Scrunch as much ribbon into the Mini Bowdabra® as you need to reach the size and fullness of scrunchy bow you wish. Use the Mini Bowdabra® Wand to scrunch down the ribbon.

3.



Scrunch down with the wand.

4.



If you're adding an embellishment, this is when you would place the wire garland or other embellishment on top of the scrunched ribbon.

Press the stem of your embellishment into the Mini Bowdabra® on top of your folded ribbon.

5.



While the bow is still in the Bowdabra®, take the ends of the tie ribbon and tie it off (don't knot it.) Gently pull the bow out of the Mini Bowdabra®. Take the ends of the tie ribbon around to the back of the bow and tie a knot.

6.



Fluff and shape the bow to create the desired appearance.

For many more inspiring ideas and additional instructions for the Mini Bowdabra®, go to www.bowdabra.com.

Fold & Twist Bow

Making beautiful bows - with a twist - is easy with the Mini Bowdabra®! This technique is great for ribbon that is different on either side - such as a fabric ribbon with a pattern on one side. Or a ribbon with a wrong and right side.

Materials Needed: the Mini Bowdabra®, the Mini Bowdabra® Wand, two-sided ribbon, and coordinating ribbon to use as a tie. You may include an embellishment of some sort, if you'd like.



1.



Lay a 12" piece of coordinating ribbon the long way into the Mini Bowdabra® to be used to tie off your bow.

2.



Lay your ribbon into the Mini Bowdabra® with right side of the pattern facing up.

Then, twist the ribbon 180 degrees as you press it into the Mini Bowdabra®. The right side of the ribbon is on the outside of the loop. You

want the "wrong" side to be hidden.

3.

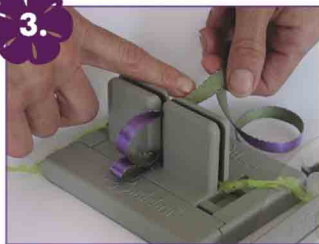

Fold the ribbon back to create a loop, then twist the ribbon 180 degrees as you press it into the Mini Bowdabra®.

Continue folding and twisting the ribbon back and forth until you create as many loops as you

wish. Use the Mini Bowdabra® Wand to scrunch down the ribbon.

4.



If you're adding an embellishment, this is when you would place the stem of the flower or embellishment on top of your folded ribbon.

Press the stem of your silk flower into the Mini Bowdabra® on top of your folded ribbon.

5.



While the bow is still in the Bowdabra®, take the ends of the tie ribbon and tie it off (don't knot it.) Gently pull the bow out of the Mini Bowdabra®. Take the ends of the tie ribbon around to the back of the bow and tie a knot.

6.



A beautiful Mini Bowdabra® Bow.